

C3 Series - C320 Data Sheet



- Wide DC range 5-24V
 - 20mm (0.8in) LCD display with RGB backlight
 - Six 9 segment characters
 - Versatile mounting options
 - Tough, compact polyester overlay
 - rinLINK connector
 - NTEP certified for conformance (23-090)
- The C320 is Rinstrum's latest compact panel mount indicator that is ideal for use in mobile applications such as forklifts, platforms, inside truck cabs, crane scales and OEM applications. Ideal for basic weight-control or level-control functions using the general or advanced setpoints and checking weighing. Both functions offer an improved operator interface with the multi-coloured backlight. Like the R3 Series the C320 can be combined with a desk mount or IP65 boot to make a full housing unit that can be used on a desk or pole mounted. The C320 supports a new range of accessory cards. The communication cards offer increased options and expansion cards cover additional functions.
- Wide DC operation (5-24V)/ USB lead: to suit a variety of onboard OEM applications. The USB lead eliminates the need for third party power supplies saving on system complexity and cost.
 - Two RS232 bidirectional serial ports: independently configurable for network, printing or remote display functions.
 - Inputs and Outputs: Two digital inputs and two high-side digital outputs that are electrically isolated. Outputs are capable of driving low voltage DC actuators directly
 - Onboard data storage: compliant to WELMEC 7.2 (alibi memory DSD)
 - rinLINK: magnetically coupled link on front fascia for easy access in situ for updates/setup of the indicator, saving the installer time and effort.
 - Flush polyester overlay with mechanical keys: no membrane key to wear out, easy to keep clean, fully sealed, durable chemical resistance, improves uv resistance.
 - Printing: Multiple standard print dockets through to fully programmable print formats that can be easily created with the drag and drop configuration tool rinPRINT.

Advanced Setpoints

The C3 instruments support up to 8 setpoints with setpoints 1 and 2 linked to the onboard digital outputs. Setpoint status can be used to drive the onboard outputs directly, sound the buzzer, change display backlight colour or can be transferred to external control systems using modbus RTU or through field bus expansion. Setpoint functions include:

- OVER/UNDER target
- CHECKWEIGH: OVER, UNDER, PASS
- Status (motion, zero, net)

Setpoint outputs can be latched and reset from remote inputs or external control.



Smart Weighing

The C320s bright, vivid backlight changes colour automatically as the pre-assigned target weights are reached.

The operator knows immediately when they've reached the acceptable weight range based on the blue, green, or red color changes for UNDER, ACCEPT, or OVER weights.

... now that's smart weighing!

C320 Specification Table

C320			
Resolution	Up to 100,000 divisions, minimum of 0.1uV/division Trade: Up to 10,000 divisions, minimum of 0.33uV/division - pending		
Zero Cancellation	± 2.0mV/V		
Span Adjustment	0.1mV/V to 5.0mV/V full scale		
Excitation	5V for up to 8 x 350-ohm load cells (4-wire or 6-wire plus shield) Max total load cell resistance: 3,500Ω		
A/D Type	24bit Sigma Delta with 8,388,608 internal counts 50 updates/second		
Operating Environment	Temperature: -10° to +50°C ambient (14° to 122° F), Humidity: <90% non-condensing, IP65 when panel mounted		
Display	RGB Backlit LCD with six 20mm (0.8") high digits with units and annunciators, 9 segment		
Setup and Calibration	Fully digital with visual prompting in plain messages		
Digital Filter	IIR low pass filter		
Zero Range	Selectable from ± 2% to ± 100% Full Scale		
Standard Power Input	5 to 24VDC, 4.8, 9.6, 12 and 24V batteries (2.5 VA max) ON/OFF key with memory feature		
Variants	AC	AC Plug pack: 110/240VAC 50/60Hz in 12VDC 1.5A out	
	Battery	4 x AA batteries (G Version or using M6001 accessory)	
Case Materials	Resin alloy		
Packing Weights	Panel Mount Indicator: 0.25kg (9oz), Full Housing: 0.42kg (14.8oz)		
Optical Data Communications	rinLINK - magnetically coupled infra-red communications Conversion cables available for USB		
Firmware Features	K301	K304	K306
Input/Outputs	-	2 isolated inputs	
	-	2 isolated, smart FET outputs (400mA total at 50VDC)	
Serial Outputs	-	2 x RS232 automatic transmit, network or printer outputs. Transmission rate: 2400-115200 baud	
Battery Backed Clock Calendar	-	Battery life 10 years minimum	
Set points	-	8 (Basic)	8 (Advanced)
Data Storage	-	Alibi WELMEC 7.2 DSD	
		-	CSV Log
Keys US Region	Power/ Zero/ Tare/ Select/ Units Switching (lb/ kg/ oz/ g/ t/ TN/ lb:oz/custom) plus two assignable function keys		
Keys ROW Region	Power/Zero/Tare/Select plus three assignable function keys		
Other	Manual hold, livestock filtering, x10 mode HiRes, linearisation		
	-	Custom printing, peak hold, counting, accumulation, medical filtering, check weighing, mimic/ remote display, mV/V calibration, ring network (rinCMD), auto tare	
Accessory Cards			
Communications cards	RS485, RS232, Current loop		
Expansion cards	Ethernet IP, Profinet, Modbus TCP, EtherCat Wi-Fi/Bluetooth		
	-	0..10V, isolated 16 bit output Analogue output 4-20mA	

Specifications may change at any time without notice.

C320 Panel Mount

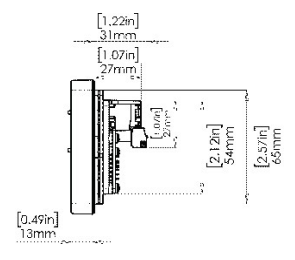
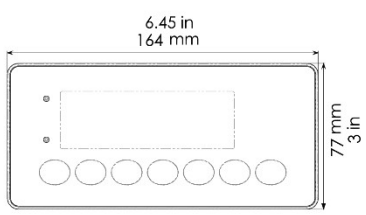

C320 with 4AA Battery Boot/ Desk Stand (Version -G)

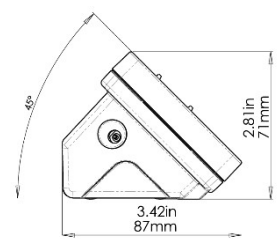
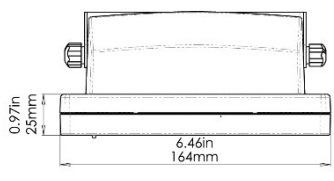
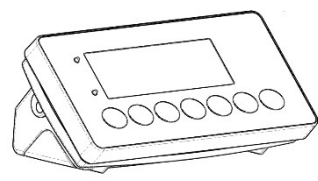

C320 Black Boots

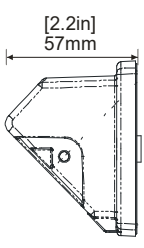
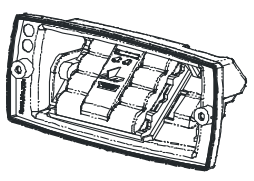

M6001

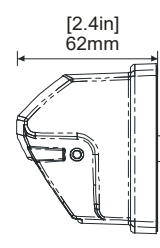
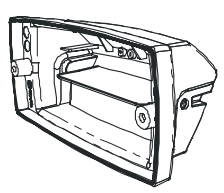

M6003

C320 Brackets



M3014



M3002



M3021

Specifications are subject to variation for improvement without notice. Illustrations are indications only and variation may be evident between products.